

Walkthrough R.M.S. Titanic

(c) by stefan.schoenfelder@web.de

A, Keller

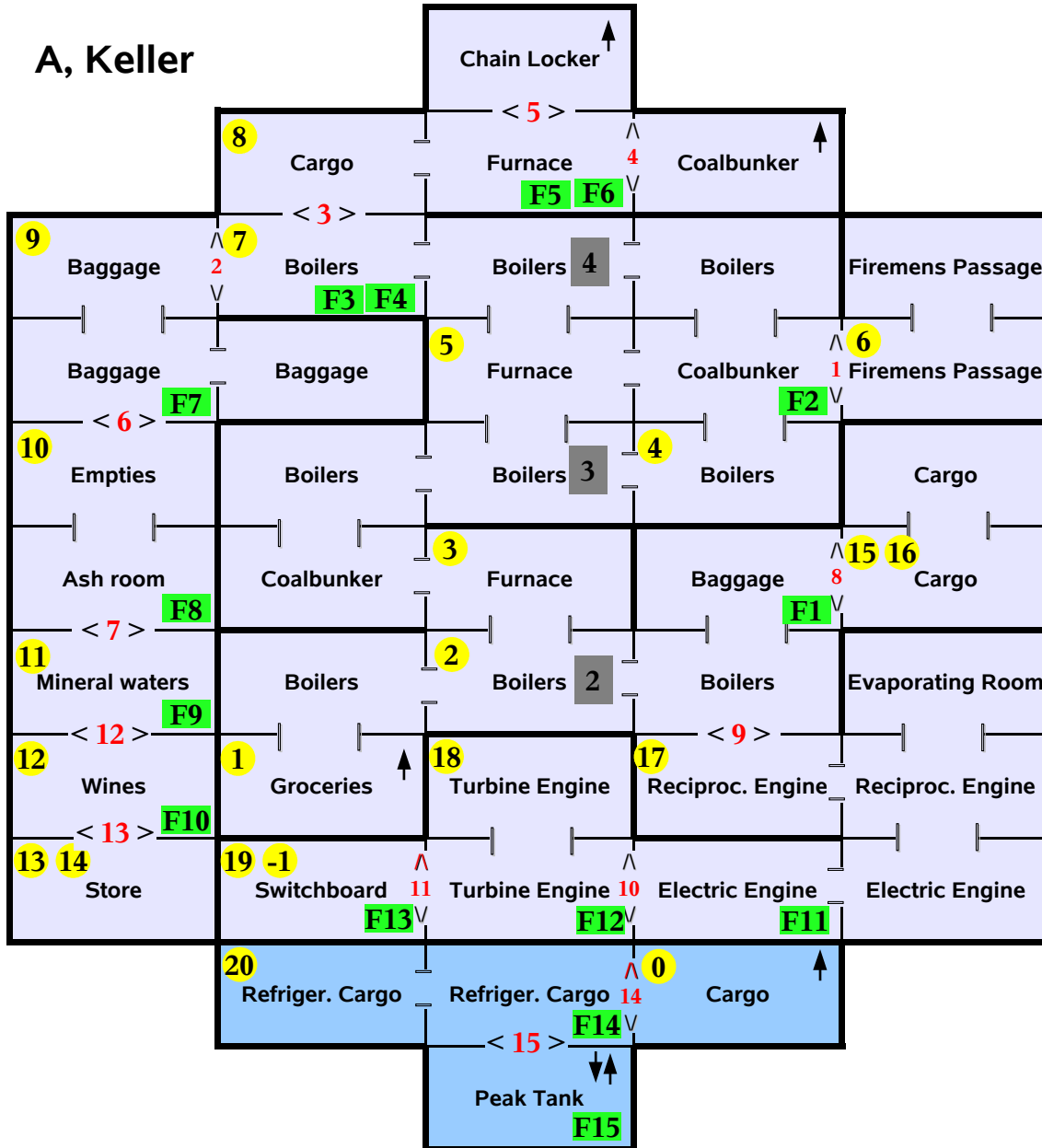

- ① item moveable
- ① item invisible
- entrance
- item fix
- item fix invis.
- < 1 > locked door
- | open door

Keller

Sache beweglich	Sache fest	Türen
-1 grid		
0 ! tea		
1 bottle of cherries	F1 lock	<1>: 4,5 (F2) => 4b
2 half key with baggage claim	F2 pile of coal	<2>: 7 (F3)
3 half key b: key	F3 lock	<3>: 9 (F4)
bucket 4 b: bucket full of coal	F4 giant clam	<4>: R (F5)
5 shovel	F5 coal chute	<5>: 31 (F6)
6 axe	F6 chain	<6>: 4b (F7)
7 pick	F7 suitcase	<7>: 8 (F8)
8 ! young ash tree	F8 pile of ash	<8>: 3b (F1)
9 string of pearls	F9 cork	<9>: 6,16
dead battery (send to lab) 10 b: recharged battery	F10 button	<10>: 10b (F11)
11 battle of mineral water	F11 electric lock	<11>: 29 (F12)
12 bottle of champagner	F12 watering can	<12>: 18 (F9)
13 iron	F13 switches	<13>: 19 (F10)
2 dozen shelled 14 walnuts b: walnuts	F14 pigskin	<14>: 23,25,0
15 case of 'Fungera' filter paper	F15 ballast	<15>: 30 (F14)
16 american express co. oak beams		
17 oil cup		
18 screw		
19 notepad		
cold ham 20 b: cured ham c: roll of ham		

Walkthrough R.M.S. Titanic

B, Basement

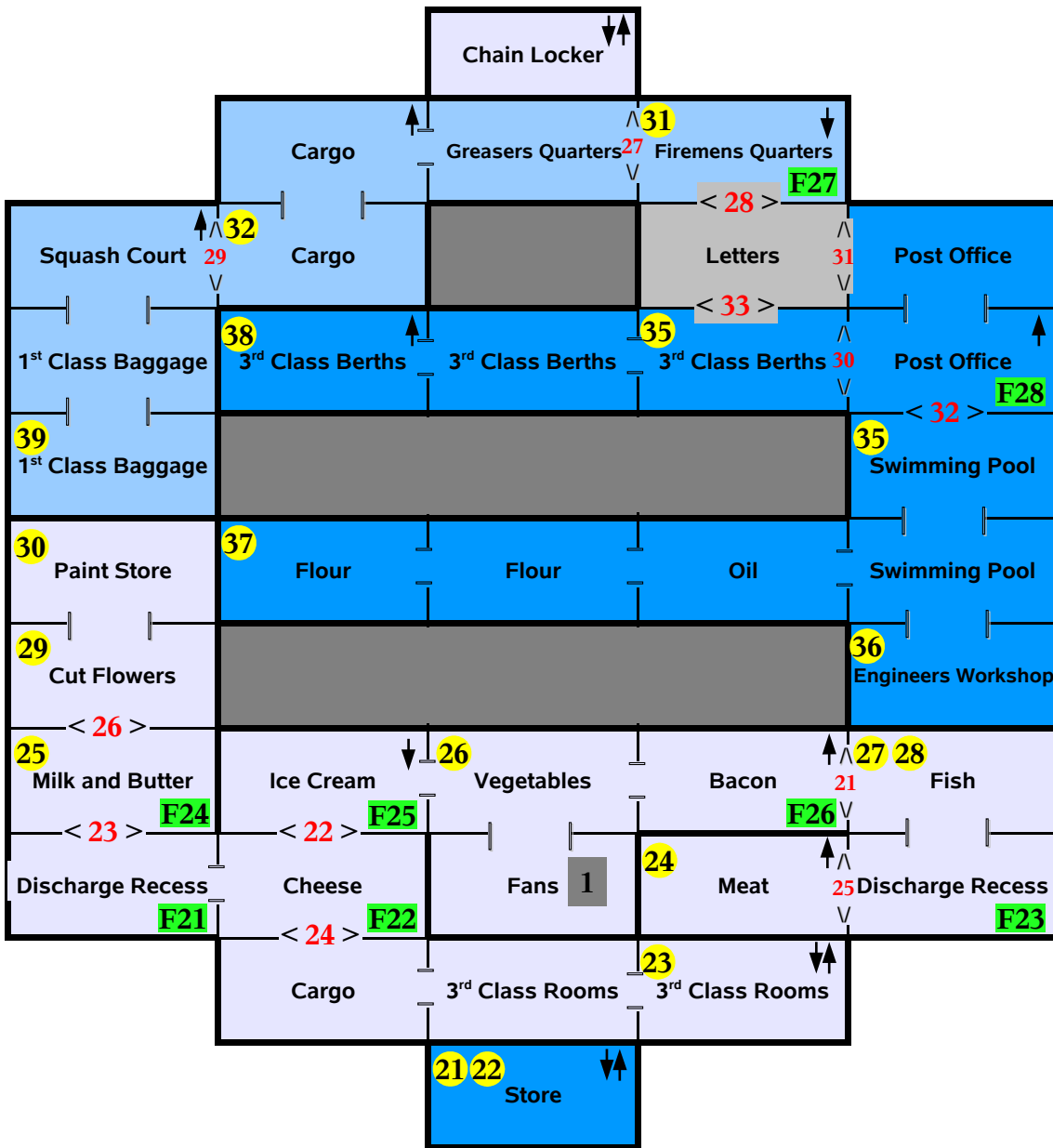

Basement

Sache beweglich	Sache fest	Türen
21 pliers	F21 purifier	<21>: 81 (F26)
22 potatoes b: peeled potatoes	F22 leicester b: red leicester (?)	<22>: 1 (F25)
23 tea urn	F23 squid	<23>: 15 (F21)
24 ! side of beef	F24 butter	<24>: 27 (F22) => F22b
25 milk	F25 sundae	<25>: 28,85 (F23)
26 lettuce	F26 hand of ham	<26>: 17 (F24)
27 red hering	F27 drinking spa	<27>: 11 (F27)
28 smoked salmon	F28 ink pad	<28>: ?
29 rose		<29>: 35,104
30 tin of paint		<30>: 98 (F28)
31 hacksaw		<31>: ?
32 dragons blood		<32>: 70,103
33 cigarette stub		<33>: ?
34 - n/a -		
35 beach ball		
36 greasy overall		
37 Flour		
38 gentlemans underwear		
39 toy steam engine		

Walkthrough R.M.S. Titanic

C, Erster Stock

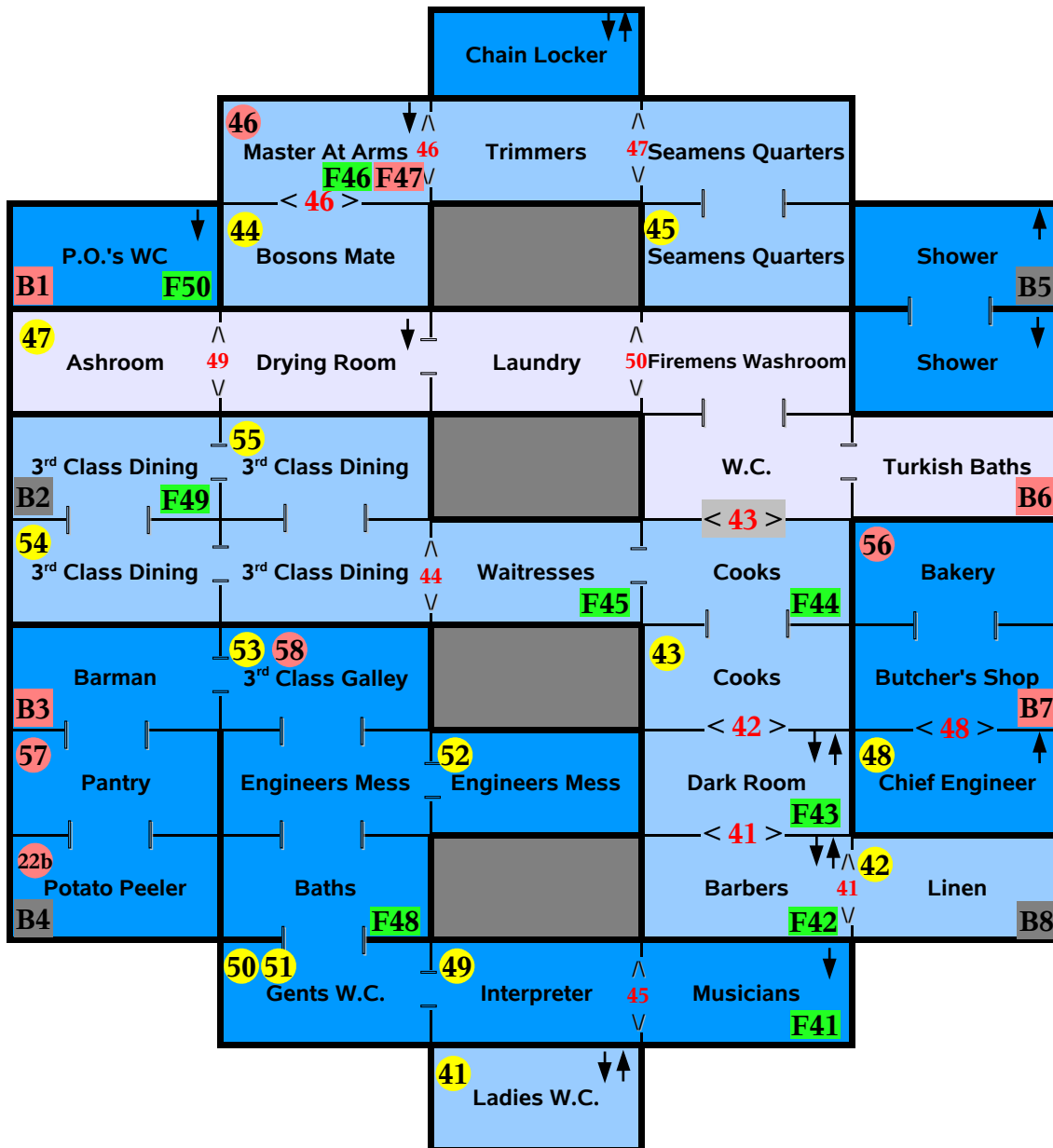

Erster Stock

Sache beweglich	Sache fest	Türen
41 toilet roll	F41 piano	<41>: 88(F42)=>F42b
42 sheets	bald wig F42 b: wig with blue ribbon	<42>: F42b (F43)
43 orange sauce	F43 cutting machine	<43>: ?
44 bits of sailcloth	F44 creme broulle (?)	<44>: 65 (F45)
45 address book	F45 borsch	<45>: 114,102,69 (F41)
46 magnum	F46 gun locker	<46>: 12 (F46) => 46 (F47); 14 (F47) => 14b
dirty towel 47 b: clean towel (@ laundry)	F47 2 dozen magnum shells	<47>: 44, 112
48 joint wiping kit	F48 bath (?)	<48>: 36b, 39
49 russian/english dictionary (?)	F49 dirty painting	<49>: 33,99
50 toilet (?)	F50 toilet	<50>: 47,36 => 47b, 36b
51 chain		
52 steamed pudding	B1 51:F50,R:F50=>60	
53 drinking straw	B2 60	
54 bill	B3 58	
55 tobacco pouch	B4 22	
56 camel pie (37,73)	B5 last button, R	
57 chips (59,22b)	B6 47b,52	
58 camel pie, chips & salad	B7 20c,24(2x droppen)	
59 griddle (-1,21:L)	B8 R	
60 brush & cleaner		

Walkthrough R.M.S. Titanic

D, Zweiter Stock

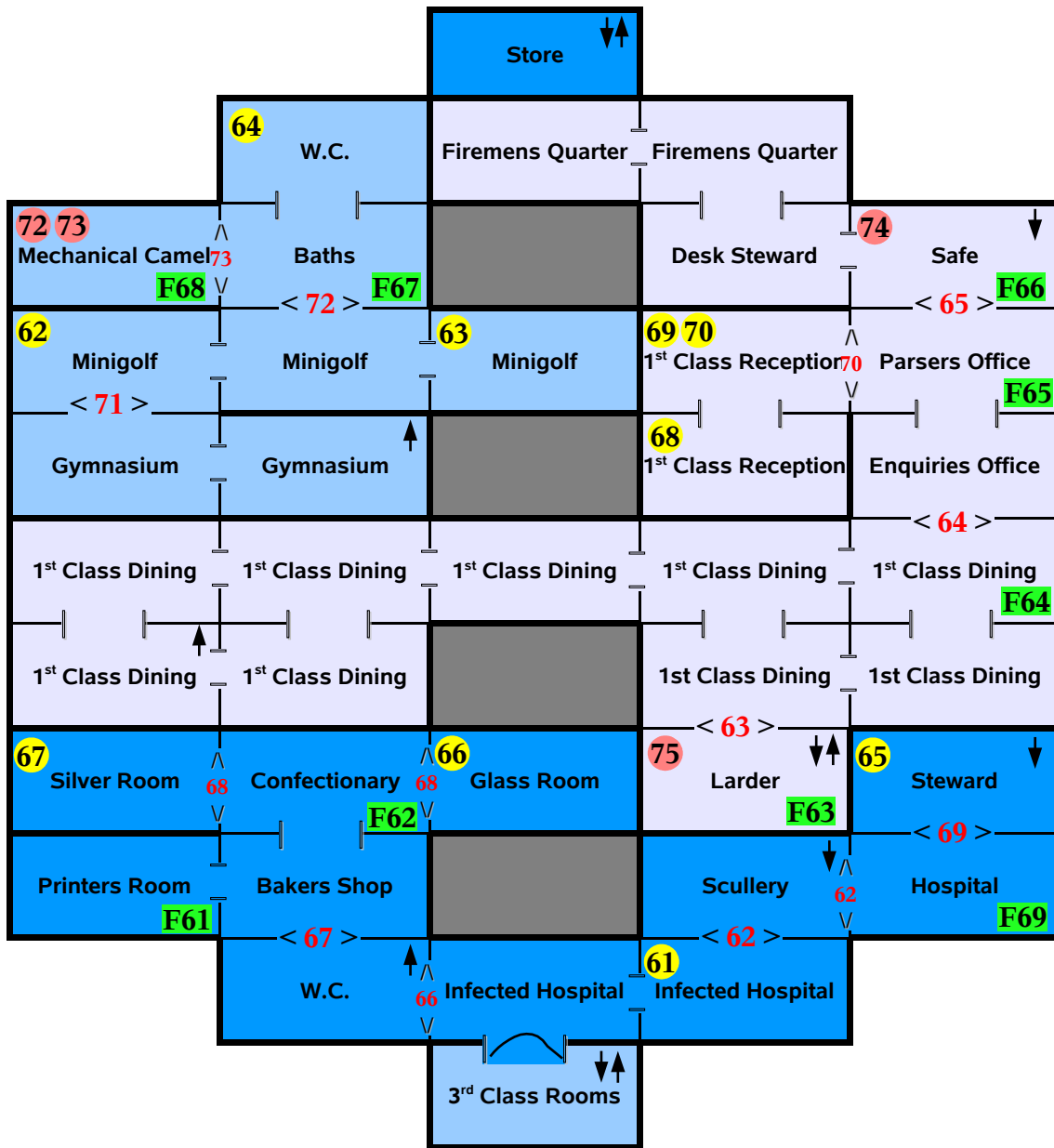

Zweiter Stock

Sache beweglich	Sache fest	Türen
61 cold medicine	F61 rack	
62 driver	F62 packet of gums	<62>: 0,24
63 9-iron	F63 green tomatoes	<63>: 89 (F63) => 75
64 soap	F64 roast duck	<64>: 43 (F64)
65 order pad	F65 bill hook	<65>: 54 (F65)
66 lead crystal	F66 button,38 => 74	<66> 61,20 => 20b
67 broken statue of horse	F67 bath	<67>: 20b,41 =>20c
68 calling card (L)=> b: card	F68 mechanical camel (53) => 72,73	<68>: 100 (F62)
69 elephant tusks	F69 mattress	<69>: 42 (F69)
70 elephant trunk	F70 elephant head	<70>: 66 (F85)
71 wallbar	F71 ball in bunker	<71>: 14b,71;R
72 broken camel (?)		<72>: 63,45 (F71)
73 camel hump		<73>: 64,115 (F67)
74 safe (?)		
75 red tomatoes		

Walkthrough R.M.S. Titanic

E, Dritter Stock



Dritter Stock

Sache beweglich	Sache fest	Türen
81 hand towel	F81 aces	<81>: 82 (F81)
82 ace	F82 walking shoe	<82>: 21 (F13),R
83 walking shoe left	F83 note	<83>: 83 (F82)
84 walking shoe right (?)	F84 n/a	<84>: 87
85 walking stick	F85 marconi set	<85>: 59
86 whalebone corset (?)	F86 pair of mules	<86>: 75
87 paper	F87 whisky & ginger ale	<87>: 55,105b
88 hair restorer	F88 ghost of Thomas St. Andrews	<88>: 97 (F86)
89 seasickness pills	F89 elephant head	<89>: 67 (F87)
90 hydrangea		<90>: 68b (F88)
91 strong box		
92 mattress		
93 jewels (?)		
94 key		
95 n/a		
96 discharge papers		
97 muffins		
98 rubber stamp		
99 ash tray		
100 bottle of 1918		
101 n/a		
102 elephant tusks		
103 elephant trunk		
104 orange squash		
105 broken pipe+48: L=> b: pipe		

Walkthrough R.M.S. Titanic

F, Sonstiges

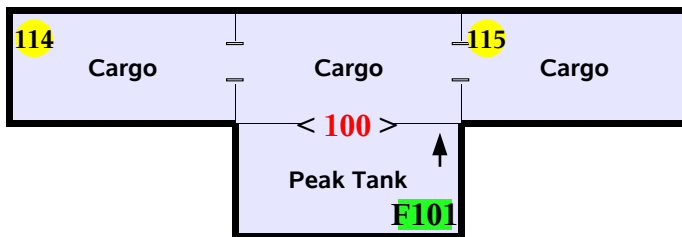
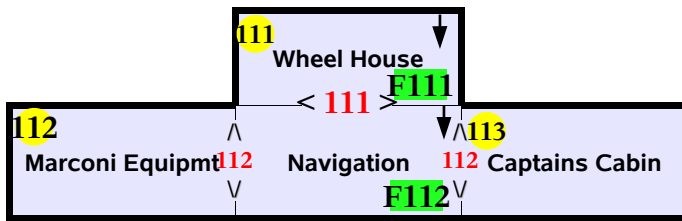

Sache beweglich	Sache fest	Türen
111 ships wheel	F111 spindle	<111>: 111,32 (F111)
112 ship in bottle	F112 chart turntable	<112>: 46 (F112)
113 buddha (?)		
114 park & tilford feather duster		
115 lasher & bernstein sponges		

Walkthrough

|5|: 81,82,<81>,83,<83>,85,87,88,<84>,89,<63>,<21>,27,28,<25>,24,<41>,
 B8,42,F42b,<42>,1,<22>,<24>,0,<62>,0,<69>,65,48,<44>,54,55,43,<64>,<65>,
 !0@<14>,!55,48@|2|,4,5,<1>,4b,6,7,<2>,9,<3>,8,<4>,31,<5>,<6>,<7>,11,10
 |2|: !10,2,3,(2,3):L,<27>,32,111,<111>,3b,10:L,<8>,15,,16,<9>,17,<23>,<26>,25
 29,30,10b,<10>,<11>,<14>,20,<15>,F:F15,21,41,61,<66>,20b,<67>,105,(105,48):L,75,
 55,105b,<87>,98,<86>,100,<68>,66,67,<89>,99,21:F13=>-1,21,R:F13=><82>,-1,21:L
 |2|: 19,18,<12>,<13>,13,14,12,(13,-1):L=>59,!12,14,<30>,33,<49>,38,38:F66,
 66:F85=><70>,<85>,59,!59@|2|,<46>,14:F47=>14b,46,<112>,112,44,<47>,45,97
 71,<71>,62,63,<72>,<88>,96,102,103,<100>,114,115
 |2|: !(115,102,114),68,69,70,<32>,35,36,37,68:L,!(35,36,37),115,114,102,<45>,R:50=>51
 53,52,47,<50>,36b,47b,!(47b,52)@B6,R:B6
 |2|: <73>,53:F68=>73,68b,51,<90>,104,<29>,39,<48>,!(37,73)@bakery => 56,26
 -1@|2|,75,22,!22 @ potatopeeler => 22b,B4,!22b @ pantry => 57,
 !(26,56,57,75)@3rd class galley => 58, !58 @ barman => B3,!50:F50,R:F50 => 51b
 B1,51b:F49 => B2,4x{90,!90 @ veranda,90,!90 @ promenade},94,R:92 => 91
 94:91 => 93,20c,24,2x{!20c,24 @ butchers} => B7, B5
 Legende: !:drop item, F: foto, R: robot arm, L: send to lab, @:location, |5|:entrance 5,
 <81>: open door 81, 81:pick item 81, (1,2):have both items in robot arm,
 B4: press button 4 with robot arm,2x{...}:perform action ... twice